





The Conex Bänninger >B< Oyster fitting is simple in concept, but versatile and efficient in practice. It is used in a wide range of applications including the installation of ball valves, radiator valves and gate valves, and can be used to quickly repair damaged sections of pipes.

Joining parallel female threaded valves and fittings with ISO 228 threads to copper or stainless steel tube is neat and simple with >B< Oyster. No need for thread cutting, PTFE tape or messy jointing compounds. With an integrated EPDM O-ring that seals against the tube and the fitting, a reliable joint is achieved all at the turn of a spanner.



Product range

For further details on our full range please visit: www.conexbanninger.com

<p>Oyster Yellow Brass</p>  <p>Y8243G From: 10 x 3/8" To: 28 x 1"</p>	<p>Oyster Red Brass</p>  <p>Y4243G From: 15 x 1/2" To: 54 x 2"</p>	<p>Oyster Nickel Plated</p>  <p>Y8243V From: 15 x 1/2" To: 22 x 3/4"</p>
<p>Expansion Coupler</p>  <p>Y3270 From: 15mm To: 54mm</p>	<p>Standard Pliers</p>  <p>Y77267 From: 10 To: 28</p>	<p>Ratchet Pliers</p>  <p>Y77266 From: 10 To: 54</p>



**Neat, easy to use
 and versatile.**

A unique transitional adaptor for threaded fittings and valves.

Conex Universal Limited: Global House, 95 Vantage Point, The Pensnett Estate, Kingswinford, West Midlands DY6 7FT, UNITED KINGDOM.
 Tel: +44 (0)121 557 2831, Fax: +44 (0)121 557 0185
 Email: salesuk@ibpgroup.com, Website: www.conexbanninger.com

Conex Bänninger products are approved by numerous Standards Authorities and Certification Bodies. This is a representation of the full range from Conex Universal Ltd. IBP trademarks are registered in numerous countries. More information online at: www.conexbanninger.com

A multiple use adaptor

The >B< Oyster adaptor is designed with a male parallel threads which allows it to be connected to a wide variety of ISO 228 parallel female threaded fittings, and makes it really versatile. Available in nickel-plate as well as yellow and red brass materials.

No flame, no mess, no fuss

Fitting with flame-free >B< Oyster couldn't be easier. All you need is the special >B< Oyster pliers and a standard, adjustable spanner. The seal is achieved via two EPDM O-rings; one internal to seal on the tube, the other to make the fitting seal.

Fully rotatable, demountable and reusable

Once fitted, the tube can be rotated through 360° whilst maintaining a reliable, leak-free joint, making an easier fit in tight spaces. >B< Oyster is just as quick and easy to demount as it is to fit, and is then ready to be used again.

Repair and expansion coupler

The >B< Oyster range includes an expansion coupler, which when fitted, can allow long runs of installed pipe-work to safely expand and contract with variations in water and ambient temperatures. Fit one >B< Oyster expander for every 12 linear metres of pipe run in order to relieve the strain on joints and pipe clips throughout the system. This combination is also ideal for quickly re-joining short sections of damaged pipe.

Applications

>B< Oyster is an extremely versatile adaptor that can be used in a wide range of domestic and commercial water applications, including central heating, drinking water and other hot and cold water system applications.

Tube compatibility

>B< Oyster can connect a range of tubes including stainless steel in accordance with EN 10312 series 1 and 2, and hard, half-hard and soft copper tube in accordance with EN 1057.

Size availability

>B< Oyster fittings are available in sizes 10 – 54 mm.

Operating pressures and temperatures

Working pressures and temperatures range between 0° and 95° (16 bar at 30°C, 12 bar at 65°C and 10 bar at 95°C).

Guarantee

When professionally installed and used in accordance with the installation instructions, >B< Oyster is guaranteed against manufacturing defects for 25 years from date of first purchase.

Visit www.conexbanninger.com for further details.

Installation guidelines

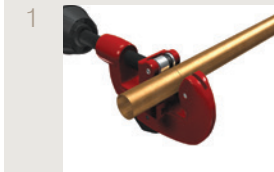

1 Cut tube to length required

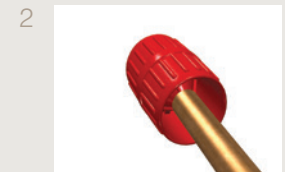

2 Deburr the tube internally and externally

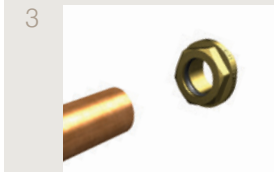

3 Assemble >B< Oyster on to tube in the correct orientation

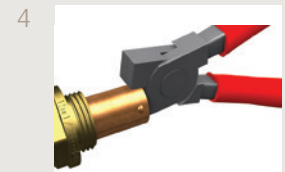

4 Add the correct number of dimples to the tube end by using the >B< Oyster pliers



5 Pull the >B< Oyster fitting against the dimples

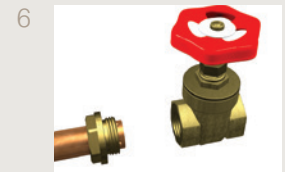

6 Insert the fitting in to the valve then hand tighten

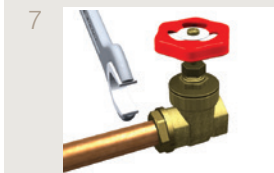

7 Tighten with a spanner until secure

Demounting

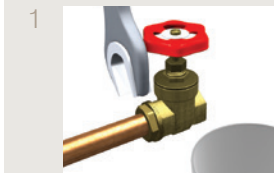

1 After turning off the water supply undo fitting using a spanner



2 Undo until fitting comes apart



Installation videos are also available on our youtube channel.

See technical brochure for full details.