

Conex Compression

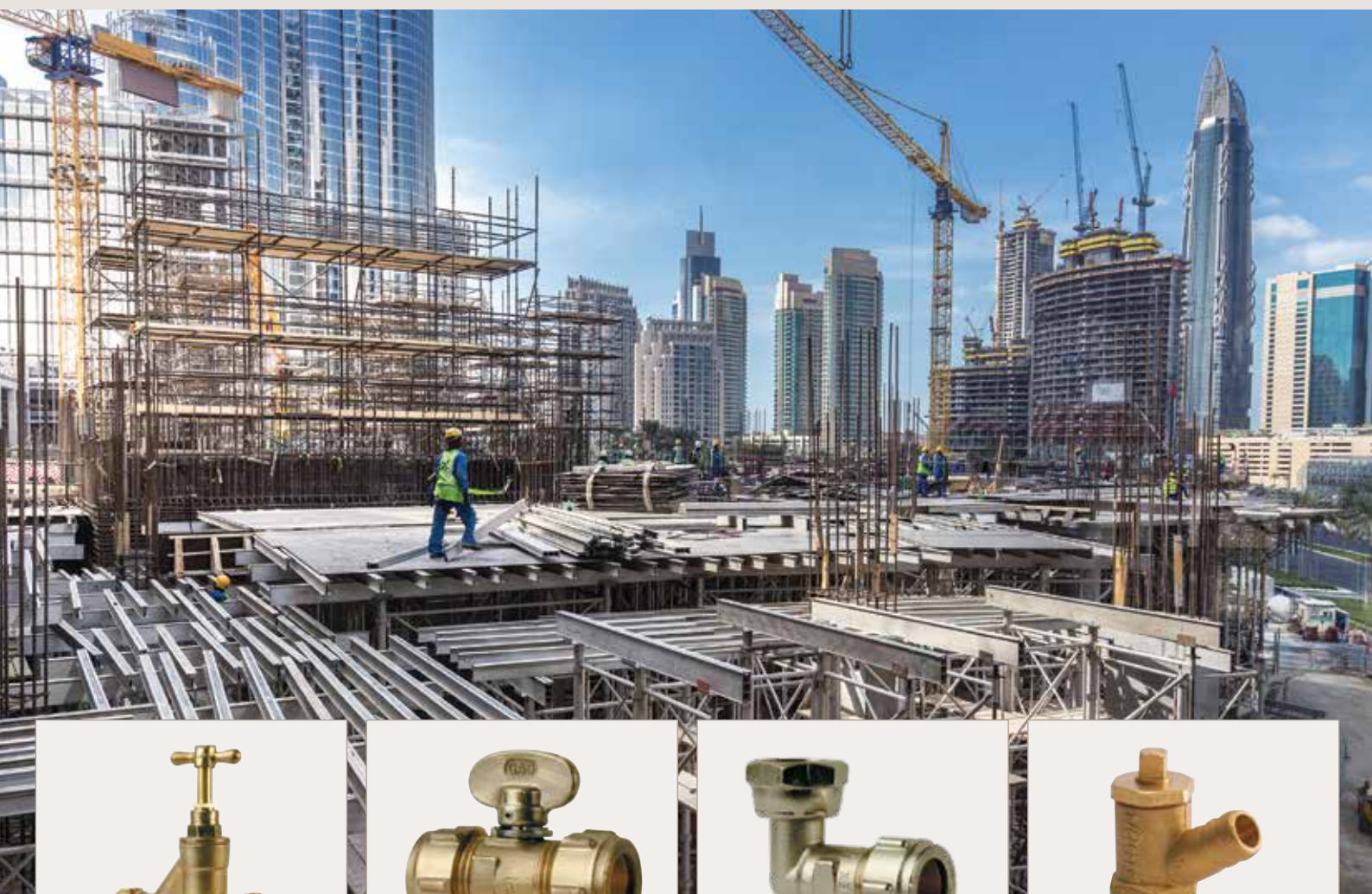

Compression Valves Technical Brochure

Conex Compression

Contents

Stopvalve 701 S701	3
Quarter Turn Lever Ball Valve 1201 1201NP S1201	5
Quarter Turn Lever Ball Valve with Tee Handle 1211	7
Servicing Valves 721NP 722NP	9
Servicing Valves 720NP	11
Draining Taps S742 S746 S746CP	13
Gas Isolating Ballvalve 1501	15
Jointing Instructions - Sizes 15 to 54mm	17
Product Guarantee	18
International Contacts	19

115 years of innovation

Conex Bänninger specialises in providing fittings, valves and accessories across the globe by offering innovative and versatile solutions. Since 1909, Conex Bänninger has produced over 24 billion fittings and valves and has built its reputation for quality European manufacturing, backed by first-class customer service and unrivalled expertise.

Passionate about excellence, Conex Bänninger is a by word for quality in the domestic, commercial, industrial, shipbuilding, air conditioning and refrigeration markets worldwide. Conex Bänninger is an ISO 9001 quality assured company, which assures you the very best in quality.



Conex Compression

Stopvalve 701 | S701

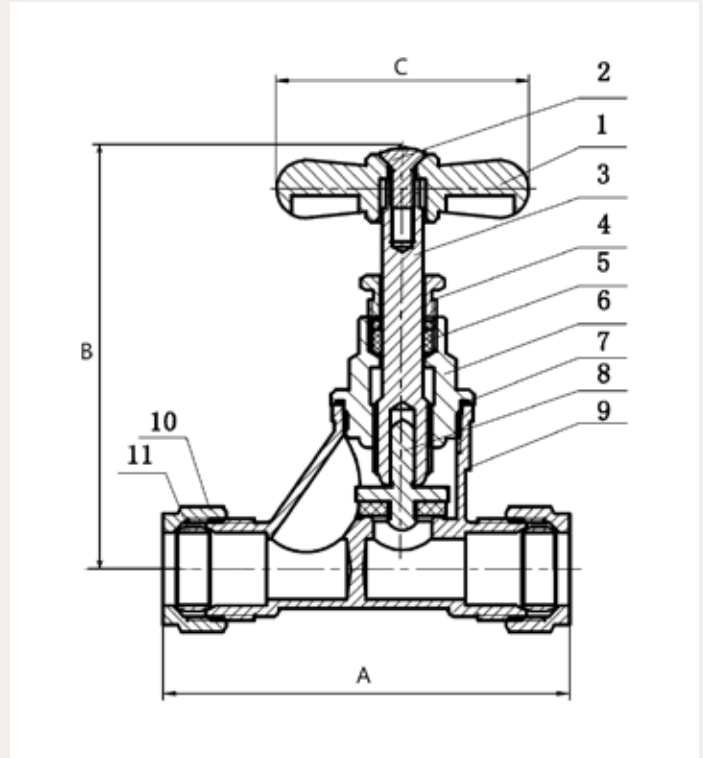

A stopvalve is a form of valve used to isolate the flow of a liquid or medium. The term is applicable to many different types of valve. The key attribute of a valve is to completely stop the flow of a medium when it is completely closed. Conex Bänninger Stopvalves are used for permitting or preventing flow and are best used in systems that require infrequent use of the valve. When fully open, full flow occurs giving minimal resistance or pressure drop.

These valves are durable and extremely reliable in use. Stopvalves open and close relatively slowly and will open and close fully when they have not been operated over a prolonged period of time. This makes them the preferred choice for applications where the valve operation is required infrequently.

Conex Bänninger Stopvalves are designed with non-rising stems making them ideal for use in applications where vertical space is limited.

Conex Bänninger Stopvalves may be used in systems involving the supply of drinking water, whilst the DZR brass and bronze valves are suitable for low temperature hot water and chilled systems.

All valves in the range are WRAS approved.

Features and benefits:

- WRAS Approved
- Designed in accordance with EN 1213
- Max Pressure rating PN 10
- Pressure rating 10 bar
- Maximum Temperature range up to 65°C
- Compression ends comply to EN 1254-2
- Unique Conex ribbed nut design 15 to 28mm, 35 to 54mm octagonal cap nuts
- DZR or Brass body

701 Brass Stopvalve

Code	Item code	Size mm	Description
701	EE-1012701--	15	701 stopvalve
701	GG-1012701--	22	701 stopvalve
701	HH-1012701--	28	701 stopvalve
701	JJ-1012701--	35	701 stopvalve
701	KK-1012701--	42	701 stopvalve
701	NN-1012701--	54	701 stopvalve

S701 DZR Brass Stopvalve

Code	Item code	Size mm	Description
S701	EE-5012701--	15	S701 stopvalve dzt
S701	GG-5012701--	22	S701 stopvalve dzt
S701	HH-5012701--	28	S701 stopvalve dzt

Valve Suitability

Product	Steam	Water	Drinking water	Oil	Air (oil free)	Gas (inert)	Gas (combustible)	Gas (corrosive)	Gas (oxygen)
701/S701	x	✓	✓	x	x	x	x	x	x

701 Brass Stopvalve Component

No	Component	Material	Specification	Qty
1	Handle	Brass	HPb59-T	1
2	Screw	Brass	HPb59-T	1
3	Stem	Brass	HPb59-T	1
4	Locknut	Brass	HPb59-T	1
5	Packing	PTFE	PTFE	1
6	Bonnet	Brass	HPb59-T	1
7	Sealing gasket	PTFE	PTFE	1
8	Sealing seat	Brass	HPb59-T, EPDM	1
9	Body	Brass	CW617N-DW	1
10	Compression nut	Brass	HPb59-T	2
11	Olive	Brass	H65	2

S701 DZR Brass Stopvalve Component

No	Component	Material	Specification	Qty
1	Handle	Brass	HPb59-T	1
2	Screw	Brass	HPb59-T	1
3	Stem	Brass	HPb59-T	1
4	Locknut	Brass	HPb59-T	1
5	Packing	PTFE	PTFE	1
6	Bonnet	Brass	HPb59-T	1
7	Sealing gasket	PTFE	PTFE	1
8	Sealing seat	Brass	HPb59-T, EPDM	1
9	Body	DZR Brass	CW511L	1
10	Compression nut	Brass	HPb59-T	2
11	Olive	Brass	H65	2

701/S701 Dimensions - A. B. C.

Code (Size mm)	Item code	A mm	B mm	C mm
701/ S701 (15)	EE-1012701-- / (DZR) EE-5012701--	73	87	51
701/ S701 (22)	GG-1012701-- / (DZR) GG-5012701--	86	94	56
701/ S701 (28)	HH-1012701-- / (DZR) HH-5012701--	99.5	138	56
701 (35)	JJ-1012701--	128	138	85
701 (42)	KK-1012701--	142	143	85
701 (54)	NN-1012701--	175	152	85

Conex Compression

Quarter Turn Lever Ball Valve **1201** | **1201NP** | **S1201**

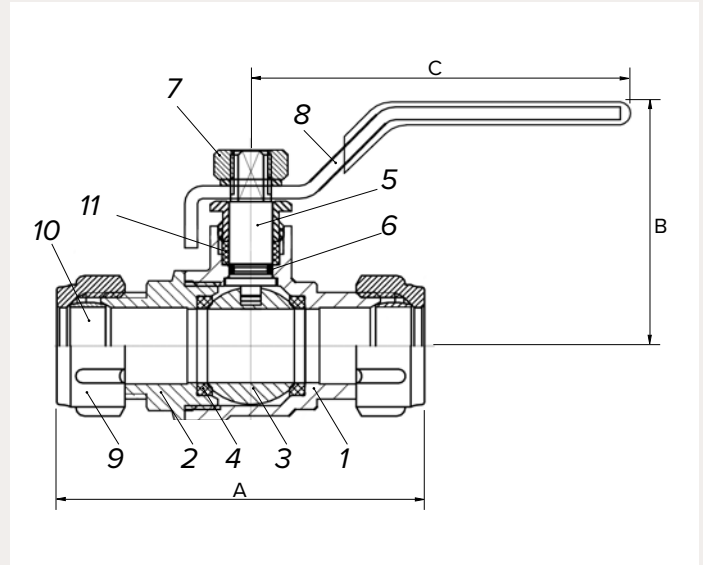

A quarter turn lever ball valve is a form of valve used to isolate the flow of a liquid or medium. The term is applicable to many different types of valve. The key attribute of a valve is to completely stop the flow of a medium when it is closed. Conex Bänninger Quarter Turn Lever Ball Valves are used for permitting or preventing flow and are particularly well suited for systems that require infrequent use of the valve. When fully open, full flow occurs giving minimal resistance or pressure drop.

These valves are durable and extremely reliable in use. They will open and close fully when they have not been operated over a prolonged period of time.

Conex Bänninger Quarter Turn Lever Ball Valves are available in brass, nickel plated brass and DZR brass versions and may be used in systems involving the supply of drinking water and low temperature hot water.

All valves in the range are WRAS approved.

Features and benefits:

- WRAS Approved
- Designed in accordance with BS EN 13828 requirements
- Max Pressure rating PN16
- Pressure rating 16 bar at <30°C
- Maximum Temperature range 110°C at 8 bar
- Compression ends comply to EN 1254-2
- Unique Conex ribbed nut design
- Lever operated quarter turn, tight shut off
- Red Lever Handle
- DZR or Brass body (available nickel plated)
- Chrome plated brass ball
- PTFE seats and stem gland seal, EPDM Stem O-ring

1201 Brass Quarter Turn Lever Ball Valve

Code	Item code	Size mm	Description
1201	EE-1021201--	15	1201 quarter turn ball valve
1201	GG-1021201--	22	1201 quarter turn ball valve
1201	HH-1021201--	28	1201 quarter turn ball valve

1201NP Nickel Plated Brass Quarter Turn Lever Ball Valve

Code	Item code	Size mm	Description
1201NP	EE-1Y21201--	15	1201 quarter turn ball valve N/P
1201NP	GG-1Y21201--	22	1201 quarter turn ball valve N/P
1201NP	HH-1Y21201--	28	1201 quarter turn ball valve N/P

S1201 DZR Brass Quarter Turn Lever Ball Valve

Code	Item code	Size mm	Description
S1201	EE-5021201--	15	S1201 quarter turn ball valve dzt
S1201	GG-5021201--	22	S1201 quarter turn ball valve dzt

Valve Suitability

Product	Steam	Water	Drinking water	Oil	Air (oil free)	Gas (inert)	Gas (combustible)	Gas (corrosive)	Gas (oxygen)
1201/S1201	x	✓	✓	✓	✓	x	x	x	x

1201/1201NP* Quarter Turn Lever Ball Valve Component

No	Component	Material	Specification	Qty
1	Body	Brass	CW617N-DW	1
2	Bonnet	Brass	HPb59-T	1
3	Ball	Brass CP	HPb59-T	1
4	Ball seat	PTFE	PTFE	1
5	Stem	Brass	HPb59-T	1
6	O-ring	EPDM	EPDM	2
7	Nut	Steel	Q235	1
8	Handle	Steel/PVC	Q235 + PVC	1
9	Compression nut	Brass	HPb59-T	2
10	Olive	Brass	H65	2
11	Packing	PTFE	-	1

S1201 Quarter Turn Lever Ball Valve Component

No	Component	Material	Specification	Qty
1	Body	Brass	CW511L	1
2	Bonnet	Brass	CW511L	1
3	Ball	Brass CP	HPb59-T	1
4	Ball seat	PTFE	PTFE	1
5	Stem	Brass	HPb59-T	1
6	O-ring	EPDM	EPDM	2
7	Nut	Steel	Q235	1
8	Handle	Steel/PVC	Q235 + PVC	1
9	Compression nut	Brass	HPb59-T	2
10	Olive	Brass	H65	2
11	Packing	PTFE	-	1

*NP = nickel plated version.

1201/DZR/NP Dimensions - A. B. C.

Code (size mm)	Item code	A mm	B mm	C mm
1201/1201NP/DZR (15)	EE-1021201--, EE-1Y21201--(NP), EE-5021201--	72.5	44.5	92
1201/1201NP/DZR (22)	GG-1021201--, GG-1Y21201--(NP), GG-5021201--	76.5	51.5	92
1201/1201NP/DZR (28)	HH-1021201--, HH-1Y21201-- (NP)	94	54	125

Conex Compression

Quarter Turn Lever Ball Valve with Tee Handle **1211**

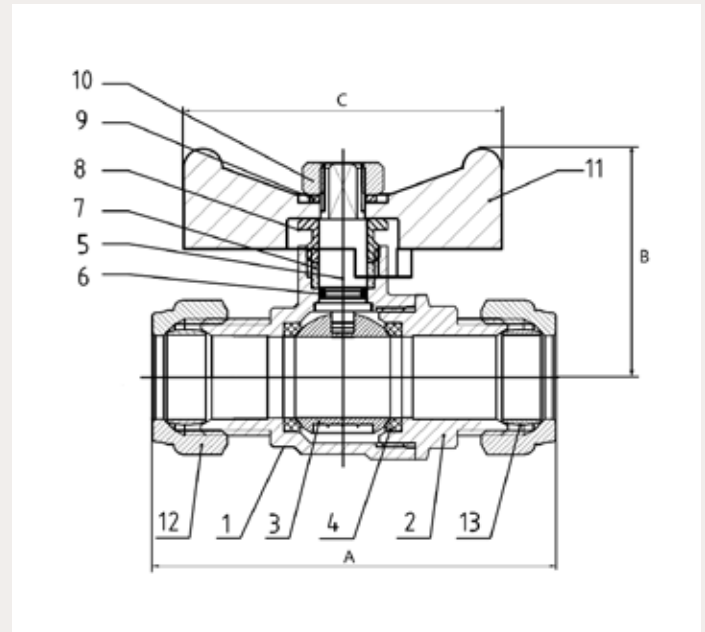

A quarter turn lever ball valve with tee handle is a form of valve used to isolate the flow of a liquid or medium. The term is applicable to many different types of valve. The key attribute of a valve is to completely stop the flow of a medium when it is completely closed. Conex Bänninger Quarter Turn Lever Ball Valves with Tee Handle are used for permitting or preventing flow and are best used in systems that require infrequent use of the valve. When fully open, full flow occurs giving minimal resistance or pressure drop.

These valves are durable and extremely reliable in use. They will open and close fully when they have not been operated over a prolonged period of time.

Conex Bänninger Quarter Turn Lever Ball Valves with Tee Handle may be used in systems involving the supply of drinking water, (whilst the DZR brass and bronze valves are suitable for low temperature hot water and chilled systems).

All valves in the range are WRAS approved.

Features and benefits:

- WRAS Approved
- Designed in accordance with BS EN 13828
- Max Pressure rating PN16
- Pressure rating 16 bar at <30°C
- Maximum Temperature range -20 to 110°C
- Compression ends comply to EN 1254-2
- Unique Conex ribbed nut design
- Aluminium Alloy Tee handle can be used for space saving purposes
- Brass body stem
- Chrome plated brass ball
- PTFE seats and stem gland seal, EPDM Stem O-ring
- Full bore quarter turn ball valve

1211 Quarter Turn Lever Ball Valve with Tee Handle

Code	Item code	Size mm	Description
1211	DD-1021211--	12	1211 quarter turn level ball valve with tee handle
1211	EE-1021211--	15	1211 quarter turn lever ball valve with tee handle
1211	GG-1021211--	22	1211 quarter turn lever ball valve with tee handle

Valve Suitability

Product	Steam	Water	Drinking water	Oil	Air (oil free)	Gas (inert)	Gas (combustible)	Gas (corrosive)	Gas (oxygen)
1211	x	✓	✓	✓	✓	x	x	x	x

1211 Quarter Turn Lever Ball Valve Component

No	Component	Material	Specification	Qty
1	Body	Brass	CW617N	1
2	Bonnet	Brass	CW617N	1
3	Ball	Brass CP	CW617N	1
4	Ball seat	PTFE	PTFE	1
5	Stem	Brass	CW617N	1
6	O-ring	EPDM	EPDM	1
7	Packing	PTFE	PTFE	1
8	Lock nut	Brass	HPb59-T	1
9	Spring washer	S Steel	SUS304	1
10	Nut	S Steel	SUS304	1
11	Red T handle	Alu alloy	Alu alloy	1
12	Compression nut	Brass	HPb59-T	2
13	Olive	Brass	H65	2

1211 Dimensions - A. B. C.

Order code (size mm)	A mm	B mm	C mm
DD-1021211--	69.7	34.5	52
EE-1021211-- (15)	72.5	34.5	52
GG-1021211--(22)	76.5	42	52

Conex Compression

Servicing Valves **721NP** | **722NP**

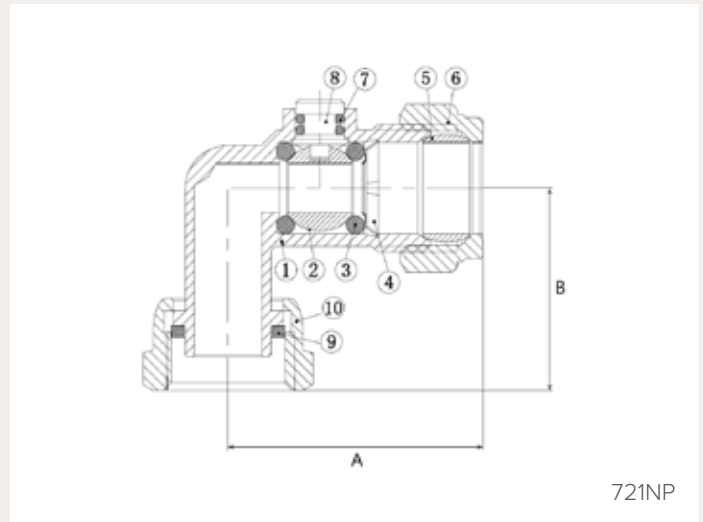

721NP

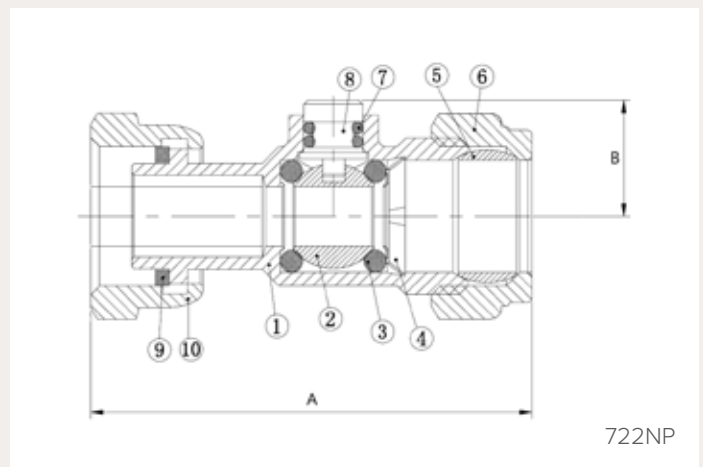

722NP

Servicing valves can shut off the flow of water and are used for maintenance or service. Isolation valves are normally fitted to taps on basins, baths, sinks, toilets, showers, washing machines, dishwashers, outside taps, cisterns, water tanks and a variety of other fixed or movable appliances.

Servicing valves fitted to appliances, like washing machines and dishwashers, tend to be supplied with a small screw to shut them off. This enables the water supply to be quickly and easily shut off with a twist of the handle.

These isolation valves are operated with a quarter turn using a flat bladed screwdriver.

Features and benefits:

- WRAS Approved
- Manufactured to BS 6675
- Max Pressure rating PN10
- Pressure rating 16 bar at <30°C
- Maximum Temperature range -10 to 85°C
- Compression ends comply to EN 1254-2
- Unique Conex ribbed nut design
- Screw operated valve - screwdriver required for safety/security
- CW617N brass body - nickel plated
- Chrome plated ball
- Female thread connection is to ISO 228

721NP Servicing Valve (elbow)

Code	Item code	Size	Description
721NP	E031512721B-	15 x 1/2"	721NP elbow swivel service valve

721NP Valve Suitability (elbow)

Product	Steam	Water	Drinking water	Oil	Air (oil free)	Gas (inert)	Gas (combustible)	Gas (corrosive)	Gas (oxygen)
721NP	x	✓	✓	x	x	x	x	x	x

721NP Servicing Valve (elbow) Component

No	Component	Material	Specification	Qty
1	Body	Brass Nickel Plated	CW617N	1
2	Ball	Brass Chrome Plated	HPb59-T	1
3	O-ring	EPDM	EPDM	2
4	Circlip	Stainless Steel	Stainless Steel	1
5	Olive	Brass	H62	1
6	Compression nut	Brass Nickel Plated	HPb59-T	1
7	O-ring	EPDM	EPDM	2
8	Stem	Brass Nickel Plated	HPb59-T	1
9	Washer	Fibre	Red fibre	1
10	Connecting nut	Brass Nickel Plated	CW617N	1

721NP (elbow) Dimensions - A. B.

Order code	A mm	B mm
E031512721B-(15 x 1/2")	40.5	41

722NP Servicing Valves (straight)

Code	Item code	Size	Description
722NP	E031512722B-	15 x 1/2"	722NP straight swivel service valve

722NP Valve Suitability (straight)

Product	Steam	Water	Drinking water	Oil	Air (oil free)	Gas (inert)	Gas (combustible)	Gas (corrosive)	Gas (oxygen)
722NP	x	✓	✓	x	x	x	x	x	x

722NP Servicing Valve (straight) Component

No	Component	Material	Specification	Qty
1	Connecting nut	Brass Nickel Plated	CW617N	1
2	Washer	Fibre	Red fibre	1
3	Body	Brass Nickel Plated	CW617N	2
4	Ball	Brass Chrome Plated	HPb59-T	1
5	Stem	Brass Nickel Plated	HPb59-T	1
6	O-ring	EPDM	EPDM	1
7	O-ring	EPDM	EPDM	2
8	Circlip	Stainless Steel	Stainless Steel	1
9	Olive	Brass	H62	1
10	Compression nut	Brass Nickel Plated	HPb59-T	1

722NP (straight) Dimensions - A. B.

Order code	A mm	B mm
E031512722B-(15 x 1/2")	40.5	41

Conex Compression

Servicing Valves **720NP**

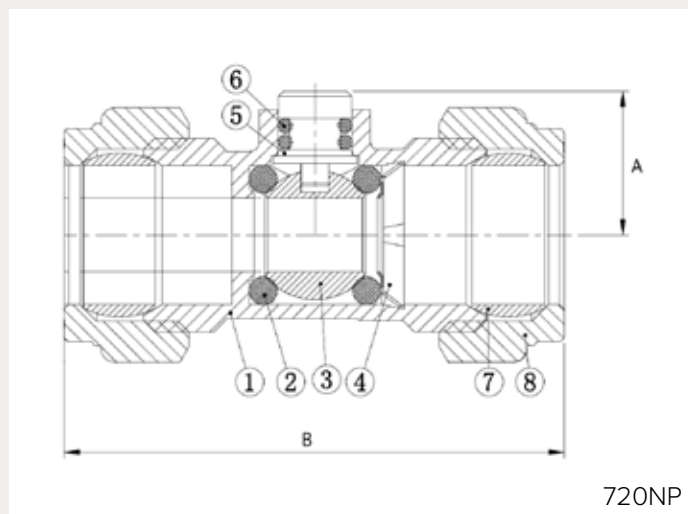

720NP

Servicing valves can shut off the flow of water and are used for maintenance or service. Isolation valves are normally fitted to taps on basins, baths, sinks, toilets, showers, washing machines, dishwashers, outside taps, cisterns, water tanks and a variety of other fixed or movable appliances.

Servicing valves fitted to appliances, like washing machines and dishwashers, tend to be supplied with a small screw to shut them off. This enables the water supply to be quickly and easily shut off with a twist of the handle.

These isolation valves are operated with a quarter turn using a flat bladed screwdriver.

Features and benefits:

- WRAS Approved
- Manufactured to BS 6675
- Max Pressure rating PN10
- Maximum Temperature range -10 to 85°C
- Compression ends comply to EN 1254-2
- Unique Conex ribbed nut design
- Screw operated valve - screwdriver required for safety/security
- Chrome plated ball
- Female thread connection is to ISO 228

720NP Servicing Valves (straight)

Code	Item code	Size mm	Description
720NP	EC-1512720B-	15 x 10	720NP straight service valve
720NP	EE-1512720B-	15 x 15	720NP straight service valve
720NP	GG-1512720B-	22 x 22	720NP straight service valve

720NP Valve Suitability (straight)

Product	Steam	Water	Drinking water	Oil	Air (oil free)	Gas (inert)	Gas (combustible)	Gas (corrosive)	Gas (oxygen)
720NP	x	✓	✓	x	x	x	x	x	x

720NP Servicing Valve (straight) Component

No	Component	Material	Specification	Qty
1	Body	Brass Nickel Plated	CW617N	1
2	O-ring	EPDM	EPDM	1
3	Ball	Brass Chrome Plated	HPb59-T	1
4	Stem	Brass Nickel Plated	HPb59-T	1
5	O-ring	EPDM	EPDM	1
6	Catch spring	Stainless Steel	SS302	1
7	Olive	Brass	H62	2
8	Compression nut	Brass Nickel Plated	HPb59-T	2

720NP (straight) Dimensions - A. B.

Order code (size mm)	A mm	B mm
EC-1512720B-(15 x 10)	15	54
EE-1512720B-(15 x 15)	15.5	54
GG-1512720B-(22 x 22)	17.5	69

Conex Compression

Drain Taps **S742** | **S746** | **S746CP (chrome plated)**

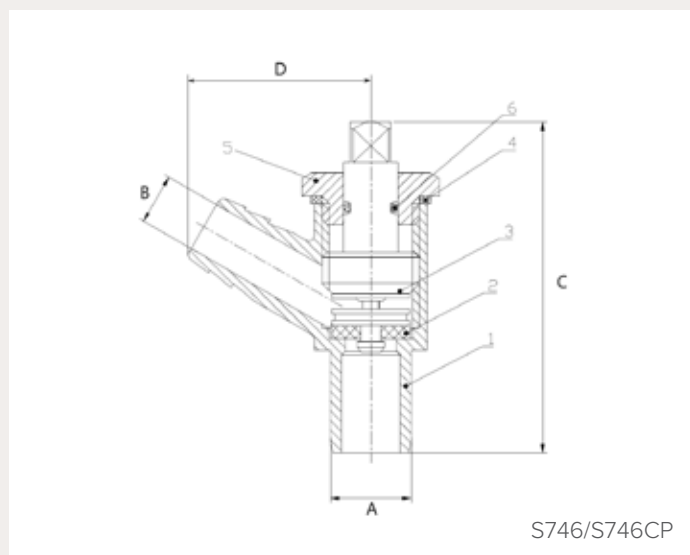
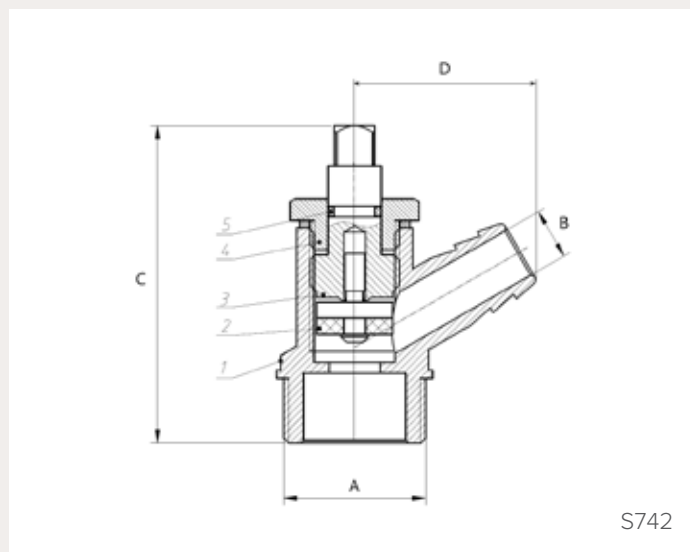

Drain taps and drain off taps can be used for multiple applications such as draining down systems, water tanks, radiators and showers.

Simply fit your drain tap to your radiator or water tank for ease of draining excess water or waste water. We advise that drain taps are installed as close as possible to the bottom of the water tank, and lowest point on a central heating system.

Features and benefits:

- WRAS Approved
- Manufactured to BS 2879-2
- Max Pressure PN10 at 30°C
- Maximum temperature 70°C (occasional excursions up to 90°C)
- Capillary end comply with EN 1254-1
- DZR brass CW511L
- Male Threads ISO 228

S742 Drain Tap (male)

Code	Item code	Size	Description
S742	03-5040742--	½"	S742 drain tap (male)

S742 Tap Suitability

Product	Steam	Water	Drinking water	Oil	Air (oil free)	Gas (inert)	Gas (combustible)	Gas (corrosive)	Gas (oxygen)
S742	x	✓	✓	x	x	x	x	x	x

S742 DrainTap (male) Component

No	Component	Material	Specification	Qty
1	Body	DZR Brass	CW511L	1
2	Washer	NBR	NBR	1
3	Stem	Brass	HPb59-T	1
4	Lock nut	Brass	HPb59-T	1
5	O-ring	NBR	NBR	1

S742 Drain Tap (male) Dimensions

Order code	A	B	C	D
03-5040742--(½")	½"	9.5mm	50mm	33.5mm

S746/S746CP Drain Tap Plain Shank

Code	Item code	Size	Description
S746	03-5040746--	½"	S746 drain tap plain shank
S746CP	03-5340746--	½"	S746 drain tap plain shank CP

S746/S746CP Tap Suitability

Product	Steam	Water	Drinking water	Oil	Air (oil free)	Gas (inert)	Gas (combustible)	Gas (corrosive)	Gas (oxygen)
S746	x	✓	✓	x	x	x	x	x	x
S746CP	x	✓	✓	x	x	x	x	x	x

S746 Drain Tap Plain Shank Component

No	Component	Material	Specification	Qty
1	Body	DZR Brass	CW511L	1
2	Washer	NBR	NBR	1
3	Stem	Brass	HPb59-T	1
4	Washer	Fibre	Red fibre	1
5	Lock nut	Brass	HPb59-T	1
6	O-ring	EPDM	EPDM	1

S746CP Drain Tap Plain Shank Description

No	Component	Material	Specification	Qty
1	Body	DZR Brass Chrome Plated	CW511L	1
2	Washer	NBR	NBR	1
3	Stem	Brass	HPb59-T	1
4	Washer	Fibre	Red fibre	1
5	Lock nut	Brass	HPb59-T	1
6	O-ring	EPDM	EPDM	1

S746/S746CP Tap Plain Shank Dimensions

Product	Order code	A	B	C	D
S746	03-5040746--(½")	15mm	9.5mm	60mm	34mm
S746CP	03-5340746--(½")	15mm	9.5mm	60mm	34mm

Conex Compression

Gas Isolating Ballvalve 1501

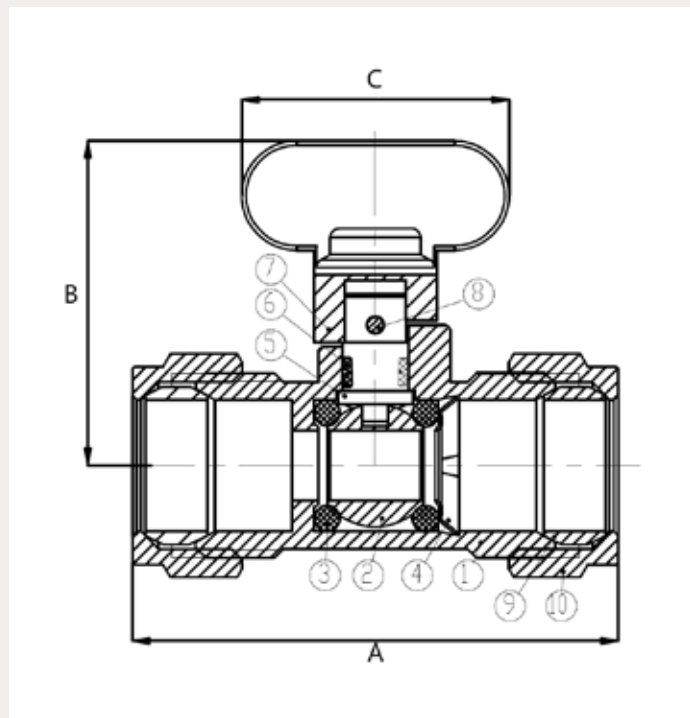

A gas isolating ballvalve is a form of valve used to isolate the flow of gas to an appliance. The key attribute of a valve is to completely stop the flow of a medium when it is completely closed.

Conex Bänninger Gas Isolating Ballvalves are used for permitting or preventing flow and are best used in systems that require infrequent use of the valve. When fully open, full flow occurs giving minimal resistance or pressure drop.

These valves are durable and extremely reliable in use. They are designed to open and close fully when they have not been operated over a prolonged period of time.

Bänninger Gas Isolating Ballvalves are installed into systems to close off the gas flow to an appliance.

Features and benefits:

- Manufactured to EN 331
- Pressure rating 5 bar (gas) at -20°C
- Maximum temperature 60°C
- Compression ends comply to EN 1254-2
- Unique Conex ribbed nut design
- Quarter turn ball valve, tight shut off
- Brass handle
- EPDM stem O-ring

1501 Gas Cock

Code	Item code	Size mm	Description
1501	EE-1021501--	15	1501 gas cock 15x15mm

1501 Valve Suitability

Product	Steam	Water	Drinking water	Oil	Air (oil free)	Gas (inert)	Gas (combustible)	Gas (corrosive)	Gas (oxygen)
1501	x	x	x	x	x	✓	✓	x	x

1501 Gas Cock Component

No	Component	Material	Specification	Qty
1	Body	Brass	CW617N	1
2	Ball	Brass	CW617N	1
3	O-ring	EPDM	EPDM	2
4	Clamp spring	Stainless Steel	SS304	1
5	Stem	Brass	CW617N	1
6	O-ring	EPDM	EPDM	2
7	Handle	Brass	CW617N	1
8	Pin	Brass	H57-30	1
9	Olive	Copper	T2	2
10	Compression nut	Brass	CW617N	2

1501 Gas Cock Dimensions - A. B. C.

Order code (size mm)	A mm	B mm	C mm
EE-1021501--(15)	55	37	30.5

Conex Compression

Joining Instructions - Sizes 15 to 54mm

All installations must be completed in line with local regulations and by-laws governing the installation, and all applicable health and safety practices must be adhered to.

For copper tubes in a R220 annealed condition and plastic pipes to BS 7291, EN 15875 and EN 15876 supporting liners must be used.

It is advisable to leave the fittings in the packaging prior to final installation to protect them from contamination and damage. As part of the installation process the space required, and the minimum distance between Conex Compression fittings, must be observed.

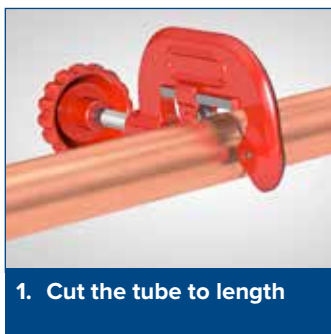

1. Cut the tube to length

- Tubes should be cut square to the required length using a rotary tube cutter or a pipe slice for plastic pipes.

Note: An angle grinder or cutting torch must not be used.

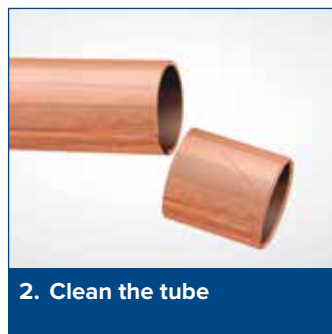

2. Clean the tube

- Once the tube has been prepared, check for any deep scratches and scores in the tube.
- If either are visible cut the tube back and start the process again.



3. Deburr internally and externally

- The tubes should then be carefully deburred inside and out to remove all sharp edges and debris.



4. Assemble 1st nut and olive

- After the tube has been prepared and checked for scores and scratches, slide on the capnut and the compression ring.



5. Assemble 2nd nut and olive (if required)

- After the first capnut and compression ring has been located on to the tube add the main body of the fitting. This can be done by screwing the body in to the capnut.
- Slide the second capnut and compression ring on to the other side of the tube.



6. Hand tighten and mark

- Insert the tube up to the tube stop in to the main body of the fittings and hand tighten.
- This should be done on both of the capnuts so that the joint is secure and fixed in place.
- Mark each capnut and fitting body, so that the number of turns can be counted.



7. Tighten the joint

- After both of the capnuts have been hand tightened use a flat face spanner, adjustable spanner (not serrated jaw type pliers) or torque wrench to tighten further.



8. Joint completion

- Remember to count the number of turns using the guidance marks on the capnut and fitting body.
- The joint is now completed.

Nut Tightening Requirement

Size (mm)	Number of turns after hand tightening & pen mark application	Equivalent torque value (Nm)
15	1 ¼	30 +/-5
22	1	40 +/-5
28	¾	55 +/-5
35 to 54	¾	100 +/-5

Product Guarantee

When professionally installed, used and maintained in accordance with the installation and maintenance instructions detailed in the Conex Compression Technical Brochure, Conex Universal Ltd. guarantees that Conex Compression fittings supplied by Conex Universal Ltd. will be free of material defects resulting from errors in manufacture, for twenty five (25) years from the date of first purchase by an end user. This Guarantee is limited to the repair or replacement of defective product(s) (at the sole discretion of Conex Universal Ltd.). At the request of Conex Universal Ltd. the allegedly defective product(s) must be returned to the address adjacent* and Conex Universal Ltd. reserves the right to inspect and test the alleged defects. This guarantee provided by Conex Universal Ltd. does not affect your statutory rights.

The guarantee set out above is given by Conex Universal Ltd. and subject to the following conditions:

- A. Any alleged defects must be reported to Conex Universal Ltd. within one month of the first occurrence of any such alleged defect, clearly setting out the nature of the claim and the circumstances surrounding it.
- B. Conex Universal Ltd. shall be under no liability in respect of any defect in any product arising from:
- defective installation,
 - fair wear and tear,
 - wilful damage,
 - negligence of any party other than Conex Universal Ltd.,
 - abnormal working or environmental conditions,
 - failure to follow the instructions of Conex Universal Ltd.,
 - misuse (which includes any use of the product(s) concerned for a purpose or in a situation / environment or for an application other than that for which it was designed), or
 - alteration or repair of any product without the prior approval of Conex Universal Ltd.

- C. At the request of Conex Universal Ltd. the person claiming under this guarantee must deliver to Conex Universal Ltd. written evidence of the date of first purchase by an end user of the product(s) concerned.

*** The address for returns is:**

Customer Services
Conex Universal Limited
Global House
95 Vantage Point
The Pensnett Estate
Kingswinford
West Midlands
DY6 7FT
UNITED KINGDOM

For specific applications, users are advised to contact Conex Universal Ltd for technical advice, or to complete their own evaluation to prove technical suitability of the products. Failure to follow this may result in damage and personal injury for which Conex Universal Ltd cannot be held liable.

All dimensions given are approximate.

>B< Press

>B< Press Gas

>B< Press Solar

>B< Press XL

>B< Press Carbon

>B< Press Inox

>B< Steel

>B< MaxiPro

>B< ACR

K65

<A> Press Inox

>B< Push

>B< Sonic

>B< Oyster

>B< Flex

Triflow Solder Ring

Delcop End Feed

Delbraze

Medical Gas

Valves

Conex Compression

Series 3000

Series 4000

Series 5000

Series 8000

OEM Solutions



United Kingdom
Conex Universal Limited

Germany
IBP GmbH

Spain
IBP Atcosa SL

France
Conex Bänninger SRL

Italy
IBP Bänninger Italia srl

Poland Sales, Marketing and Logistics
IBP Instalittings Sp z.o.o.

USA
IBP Group LLC

China
IBP China

Tel: +44 (0)121 557 2831 | Fax: +44 (0)121 557 0185 | Email: salesuk@ibpgroup.com | Website: www.conexbanninger.com

The content of this publication is for general information only. It is the user's responsibility to determine suitability of any product, product data and specifications, for the purpose intended and reference should be made to our Technical Department if clarification is required – technical@ibpgroup.com. All products must be installed in accordance with our installation instructions. In the interests of technical development we reserve the right to change specification, design and materials without notice.

Conex Bänninger products are approved by numerous Standards Authorities and Certification Bodies. This is a representation of the full range from Conex Universal Ltd. Patents and trademarks are registered in numerous countries. Details on registered and pending patents protecting our products is available at public patent registers or can be requested from legal@ibpgroup.com. All documents, images and technical data are © of Conex Universal Limited. E&OA.